

# B solderless terminals

non insulated

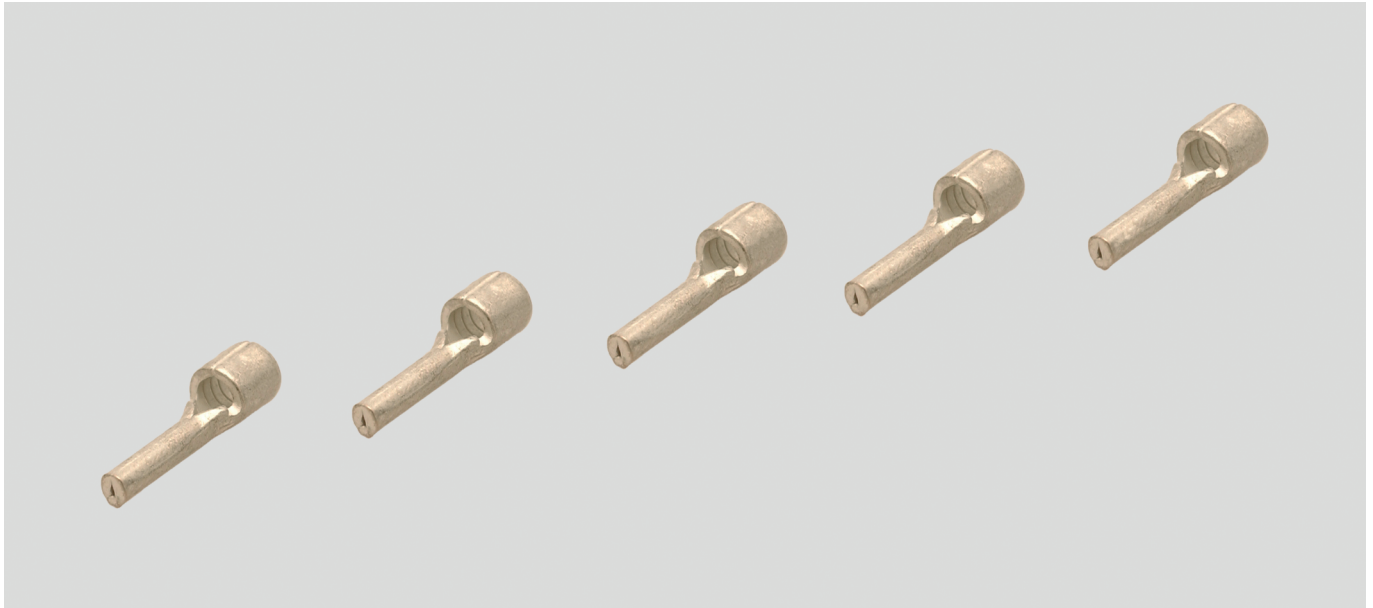

## Solderless terminals B

Non-insulated squeeze snap-on connection in pin design.

## Material

Copper  
Surface: tinned

## Technical data

Temperature range: up to +125°C

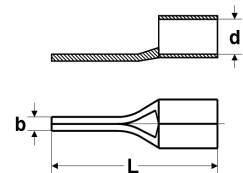

## Dimensions

- a Stick length
- d Inner diameter of the cable insertion
- b Stick width
- L Total length

## round pattern

Part no.	Type	Cross-section mm <sup>2</sup>	a mm	b mm	d mm	t mm	l mm	Weight kg / 1000 items	Unit	Net EUR/100 items at a purchase of		
										up to 500	501 - 1000	1001 - 5000
91556	B 0,5P	0,5-1,5	10,0	1,9	-	-	17,0	0,6	100	o. r.	o. r.	o. r.
91557	B 2,5P	1,5-2,5	10,0	1,9	-	-	17,0	0,7	100	o. r.	o. r.	o. r.
91558	B 6P	2,5-6,0	11,0	2,7	-	-	20,0	1,6	100	o. r.	o. r.	o. r.
91559	B 10P	10	11,0	4,3	-	-	24,5	2,7	100	o. r.	o. r.	o. r.
91560	B 16P	16	15,0	5,8	-	-	29,5	3,9	100	o. r.	o. r.	o. r.
91378	B 25P	25	15,0	6,8	-	-	33,5	6,3	1	o. r.	o. r.	o. r.
91379	B 35P	35	20,0	8,0	-	-	40,5	11,7	1	o. r.	o. r.	o. r.
91380	B 50P	50	20,0	9,5	-	-	45,0	17,9	1	o. r.	o. r.	o. r.
91381	B 70P	70	23,0	11,0	-	-	55,0	28,2	1	o. r.	o. r.	o. r.
91377	B 95P	95	23,0	12,5	-	-	55,0	43,0	1	o. r.	o. r.	o. r.

Dimensions and specifications may be changed without prior notice.

o. r. = on request