

HELU-S-RK-CU-UL кабельный наконечник - прямой



неизолированный



HELU-S-RK-CU-UL кабельный наконечник

Неизолированные прямые кабельные наконечники круглой формы

Материал

Гильза: медь в соотв. с DIN EN 13600
Поверхность: гальваническое лужение

Примечания

Также доступны в угловом исполнении (45° и 90°)

Технические характеристики

Температурный диапазон: до +120°C

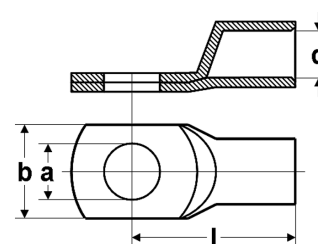

Размеры

- a Диаметр отверстия
- d Внутренний диаметр жилы части
- b Ширина фланца
- l Длина до середины отверстия

| Артикул | Тип | Сечение мм ² | a мм | d мм | b мм | l мм | Индекс, тип | Вес кг / 1000 штук | У.б. шт. |
|---------|-----------------------|-------------------------|------|------|------|------|-------------|--------------------|----------|
| 907318 | HELU-S-RK-CU-UL 6-4 | 6,0 | 4,3 | 3,5 | 10,0 | 19,0 | - | 4,6 | 100 |
| 907319 | HELU-S-RK-CU-UL 6-5 | 6,0 | 5,3 | 3,5 | 10,0 | 20,0 | - | 4,7 | 100 |
| 907320 | HELU-S-RK-CU-UL 6-6 | 6,0 | 6,4 | 3,5 | 11,0 | 21,5 | - | 5,4 | 100 |
| 907321 | HELU-S-RK-CU-UL 6-8 | 6,0 | 8,4 | 3,5 | 15,0 | 24,0 | - | 5,9 | 100 |
| 907322 | HELU-S-RK-CU-UL 6-10 | 6,0 | 10,5 | 3,5 | 18,0 | 26,0 | - | 6,4 | 100 |
| 907323 | HELU-S-RK-CU-UL 6-12 | 6,0 | 13,0 | 3,5 | 19,0 | 27,5 | - | 6,4 | 100 |
| 907324 | HELU-S-RK-CU-UL 10-4 | 10,0 | 4,3 | 4,5 | 12,0 | 20,0 | - | 4,3 | 100 |
| 907325 | HELU-S-RK-CU-UL 10-5 | 10,0 | 5,3 | 4,5 | 12,0 | 21,0 | - | 4,8 | 100 |
| 907326 | HELU-S-RK-CU-UL 10-6 | 10,0 | 6,4 | 4,5 | 12,0 | 22,5 | - | 5,1 | 100 |
| 907327 | HELU-S-RK-CU-UL 10-8 | 10,0 | 8,4 | 4,5 | 15,0 | 25,0 | - | 5,8 | 100 |
| 907328 | HELU-S-RK-CU-UL 10-10 | 10,0 | 10,5 | 4,4 | 18,0 | 27,0 | - | 6,3 | 100 |
| 907329 | HELU-S-RK-CU-UL 10-12 | 10,0 | 13,0 | 4,5 | 20,0 | 28,5 | - | 6,3 | 100 |
| 907330 | HELU-S-RK-CU-UL 16-4 | 16,0 | 4,3 | 5,5 | 12,0 | 24,0 | - | 8,2 | 100 |
| 907331 | HELU-S-RK-CU-UL 16-5 | 16,0 | 5,3 | 5,5 | 12,0 | 25,0 | - | 8,9 | 100 |
| 907332 | HELU-S-RK-CU-UL 16-6 | 16,0 | 6,4 | 5,5 | 12,0 | 26,5 | - | 9,6 | 100 |
| 907333 | HELU-S-RK-CU-UL 16-8 | 16,0 | 8,4 | 5,5 | 15,0 | 29,0 | - | 10,3 | 100 |
| 907334 | HELU-S-RK-CU-UL 16-10 | 16,0 | 10,5 | 5,5 | 18,0 | 31,0 | - | 11,0 | 100 |
| 907335 | HELU-S-RK-CU-UL 16-12 | 16,0 | 13,0 | 5,5 | 19,0 | 32,0 | - | 10,8 | 100 |
| 907336 | HELU-S-RK-CU-UL 25-5 | 25,0 | 5,3 | 7,0 | 15,0 | 33,5 | - | 13,5 | 100 |
| 907337 | HELU-S-RK-CU-UL 25-6 | 25,0 | 6,4 | 7,0 | 15,0 | 31,5 | - | 13,1 | 100 |
| 907338 | HELU-S-RK-CU-UL 25-8 | 25,0 | 8,4 | 7,0 | 16,0 | 33,0 | - | 12,9 | 100 |
| 907339 | HELU-S-RK-CU-UL 25-10 | 25,0 | 10,5 | 7,0 | 18,0 | 34,5 | - | 14,6 | 100 |
| 907340 | HELU-S-RK-CU-UL 25-12 | 25,0 | 13,0 | 7,0 | 20,0 | 36,0 | - | 15,5 | 100 |
| 907341 | HELU-S-RK-CU-UL 25-14 | 25,0 | 15,0 | 7,0 | 22,0 | 39,0 | - | 16,6 | 100 |
| 907342 | HELU-S-RK-CU-UL 25-16 | 25,0 | 17,0 | 7,0 | 24,0 | 42,0 | - | 17,3 | 100 |
| 907343 | HELU-S-RK-CU-UL 35-6 | 35,0 | 6,4 | 8,5 | 17,0 | 33,0 | - | 20,7 | 100 |
| 907344 | HELU-S-RK-CU-UL 35-8 | 35,0 | 8,4 | 8,5 | 17,0 | 34,0 | - | 21,8 | 100 |
| 907345 | HELU-S-RK-CU-UL 35-10 | 35,0 | 10,5 | 8,5 | 20,0 | 36,5 | - | 21,9 | 100 |
| 907346 | HELU-S-RK-CU-UL 35-12 | 35,0 | 13,0 | 8,5 | 22,0 | 37,5 | - | 23,3 | 100 |
| 907347 | HELU-S-RK-CU-UL 35-14 | 35,0 | 15,0 | 8,5 | 23,0 | 40,0 | - | 24,4 | 100 |

Продолжение ►

HELU-S-RK-CU-UL кабельный наконечник - прямой



неизолированный

| Артикул | Тип | Сечение мм ² | a мм | d мм | b мм | l мм | Индекс, тип | Вес кг / 1000 штук | У.Б. шт. |
|---------|------------------------|-------------------------|------|------|------|-------|-------------|--------------------|----------|
| 907348 | HELU-S-RK-CU-UL 35-16 | 35,0 | 17,0 | 8,5 | 28,0 | 44,0 | - | 26,0 | 100 |
| 907349 | HELU-S-RK-CU-UL 50-6 | 50,0 | 6,4 | 10,0 | 20,0 | 37,0 | - | 30,1 | 100 |
| 907350 | HELU-S-RK-CU-UL 50-8 | 50,0 | 8,4 | 10,0 | 20,0 | 39,0 | - | 30,4 | 100 |
| 907351 | HELU-S-RK-CU-UL 50-10 | 50,0 | 10,5 | 10,0 | 20,0 | 40,5 | - | 31,3 | 100 |
| 907352 | HELU-S-RK-CU-UL 50-12 | 50,0 | 13,0 | 10,0 | 23,0 | 42,0 | - | 31,3 | 100 |
| 907353 | HELU-S-RK-CU-UL 50-14 | 50,0 | 15,0 | 10,0 | 23,0 | 44,0 | - | 35,1 | 100 |
| 907354 | HELU-S-RK-CU-UL 50-16 | 50,0 | 17,0 | 10,0 | 27,0 | 46,0 | - | 35,5 | 100 |
| 907355 | HELU-S-RK-CU-UL 50-20 | 50,0 | 21,0 | 10,0 | 30,5 | 52,5 | - | 38,9 | 100 |
| 907356 | HELU-S-RK-CU-UL 70-6 | 70,0 | 6,4 | 12,0 | 24,0 | 40,5 | - | 41,1 | 25 |
| 907357 | HELU-S-RK-CU-UL 70-8 | 70,0 | 8,4 | 12,0 | 24,0 | 42,5 | - | 44,6 | 25 |
| 907358 | HELU-S-RK-CU-UL 70-10 | 70,0 | 10,5 | 12,0 | 24,0 | 43,5 | - | 46,4 | 25 |
| 907359 | HELU-S-RK-CU-UL 70-12 | 70,0 | 13,0 | 12,0 | 24,0 | 45,0 | - | 47,3 | 25 |
| 907360 | HELU-S-RK-CU-UL 70-14 | 70,0 | 15,0 | 12,0 | 25,0 | 46,0 | - | 49,1 | 25 |
| 907361 | HELU-S-RK-CU-UL 70-16 | 70,0 | 17,0 | 12,0 | 28,0 | 48,5 | - | 49,6 | 25 |
| 907362 | HELU-S-RK-CU-UL 70-20 | 70,0 | 21,0 | 12,0 | 29,0 | 52,0 | - | 52,9 | 25 |
| 907363 | HELU-S-RK-CU-UL 95-6 | 95,0 | 6,4 | 13,5 | 26,0 | 43,0 | - | 49,5 | 25 |
| 907364 | HELU-S-RK-CU-UL 95-8 | 95,0 | 8,4 | 13,5 | 26,0 | 46,0 | - | 53,6 | 25 |
| 907365 | HELU-S-RK-CU-UL 95-10 | 95,0 | 10,5 | 13,5 | 26,0 | 47,0 | - | 55,1 | 25 |
| 907366 | HELU-S-RK-CU-UL 95-12 | 95,0 | 13,0 | 13,5 | 26,0 | 48,0 | - | 55,1 | 25 |
| 907367 | HELU-S-RK-CU-UL 95-14 | 95,0 | 15,0 | 13,5 | 26,0 | 51,5 | - | 58,9 | 25 |
| 907368 | HELU-S-RK-CU-UL 95-16 | 95,0 | 17,0 | 13,5 | 28,0 | 51,0 | - | 58,5 | 25 |
| 907369 | HELU-S-RK-CU-UL 95-20 | 95,0 | 21,0 | 13,5 | 30,0 | 55,0 | - | 61,3 | 25 |
| 907370 | HELU-S-RK-CU-UL 120-8 | 120,0 | 8,4 | 15,0 | 29,0 | 49,5 | - | 68,8 | 25 |
| 907371 | HELU-S-RK-CU-UL 120-10 | 120,0 | 10,5 | 15,0 | 29,0 | 52,0 | - | 79,9 | 25 |
| 907372 | HELU-S-RK-CU-UL 120-12 | 120,0 | 13,0 | 15,0 | 29,0 | 51,5 | - | 78,4 | 25 |
| 907373 | HELU-S-RK-CU-UL 120-14 | 120,0 | 15,0 | 15,0 | 30,0 | 53,0 | - | 78,6 | 25 |
| 907374 | HELU-S-RK-CU-UL 120-16 | 120,0 | 17,0 | 15,0 | 30,0 | 55,0 | - | 80,7 | 25 |
| 907375 | HELU-S-RK-CU-UL 120-20 | 120,0 | 21,0 | 15,0 | 35,0 | 60,0 | - | 89,0 | 25 |
| 907376 | HELU-S-RK-CU-UL 150-8 | 150,0 | 8,4 | 16,8 | 31,0 | 55,5 | - | 78,9 | 25 |
| 907377 | HELU-S-RK-CU-UL 150-10 | 150,0 | 10,5 | 16,8 | 31,0 | 56,5 | - | 83,7 | 25 |
| 907378 | HELU-S-RK-CU-UL 150-12 | 150,0 | 13,0 | 16,8 | 31,0 | 56,0 | - | 80,7 | 25 |
| 907379 | HELU-S-RK-CU-UL 150-14 | 150,0 | 15,0 | 16,8 | 31,0 | 57,0 | - | 83,0 | 25 |
| 907380 | HELU-S-RK-CU-UL 150-16 | 150,0 | 17,0 | 16,8 | 31,0 | 58,0 | - | 83,6 | 25 |
| 907381 | HELU-S-RK-CU-UL 150-20 | 150,0 | 21,0 | 16,8 | 35,0 | 63,0 | - | 87,5 | 25 |
| 907382 | HELU-S-RK-CU-UL 185-8 | 185,0 | 8,4 | 19,0 | 35,0 | 58,0 | - | 103,7 | 25 |
| 907383 | HELU-S-RK-CU-UL 185-10 | 185,0 | 10,5 | 19,0 | 35,0 | 59,0 | - | 106,1 | 25 |
| 907384 | HELU-S-RK-CU-UL 185-12 | 185,0 | 13,0 | 19,0 | 35,0 | 58,5 | - | 106,0 | 25 |
| 907385 | HELU-S-RK-CU-UL 185-14 | 185,0 | 15,0 | 19,0 | 35,0 | 61,0 | - | 107,2 | 25 |
| 907386 | HELU-S-RK-CU-UL 185-16 | 185,0 | 17,0 | 19,0 | 35,0 | 63,0 | - | 108,6 | 25 |
| 907387 | HELU-S-RK-CU-UL 185-20 | 185,0 | 21,0 | 19,0 | 35,0 | 66,0 | - | 113,3 | 25 |
| 907388 | HELU-S-RK-CU-UL 240-8 | 240,0 | 8,4 | 21,0 | 38,0 | 67,0 | - | 124,0 | 25 |
| 907389 | HELU-S-RK-CU-UL 240-10 | 240,0 | 10,5 | 21,0 | 38,0 | 67,0 | - | 129,7 | 25 |
| 907390 | HELU-S-RK-CU-UL 240-12 | 240,0 | 13,0 | 21,0 | 38,0 | 67,0 | - | 130,2 | 25 |
| 907391 | HELU-S-RK-CU-UL 240-14 | 240,0 | 15,0 | 21,0 | 38,0 | 69,0 | - | 133,6 | 25 |
| 907392 | HELU-S-RK-CU-UL 240-16 | 240,0 | 17,0 | 21,0 | 38,0 | 69,5 | - | 135,6 | 20 |
| 907393 | HELU-S-RK-CU-UL 240-20 | 240,0 | 21,0 | 21,0 | 38,0 | 71,0 | - | 138,0 | 25 |
| 907394 | HELU-S-RK-CU-UL 300-10 | 300,0 | 10,5 | 24,0 | 44,0 | 79,5 | - | 204,5 | 20 |
| 907395 | HELU-S-RK-CU-UL 300-12 | 300,0 | 13,0 | 24,0 | 44,0 | 82,0 | - | 211,8 | 20 |
| 907396 | HELU-S-RK-CU-UL 300-14 | 300,0 | 15,0 | 24,0 | 44,0 | 84,0 | - | 221,9 | 20 |
| 907397 | HELU-S-RK-CU-UL 300-16 | 300,0 | 17,0 | 24,0 | 44,0 | 85,0 | - | 219,4 | 20 |
| 907398 | HELU-S-RK-CU-UL 300-20 | 300,0 | 21,0 | 24,0 | 44,0 | 85,0 | - | 224,0 | 20 |
| 907399 | HELU-S-RK-CU-UL 400-10 | 400,0 | 10,5 | 27,5 | 49,0 | 92,0 | - | 279,0 | 15 |
| 907400 | HELU-S-RK-CU-UL 400-12 | 400,0 | 13,0 | 27,5 | 49,0 | 92,0 | - | 278,5 | 15 |
| 907401 | HELU-S-RK-CU-UL 400-16 | 400,0 | 17,0 | 27,5 | 49,0 | 92,0 | - | 276,5 | 15 |
| 907402 | HELU-S-RK-CU-UL 400-20 | 400,0 | 21,0 | 27,5 | 49,0 | 92,0 | - | 266,1 | 15 |
| 907403 | HELU-S-RK-CU-UL 500-12 | 500,0 | 13,0 | 31,0 | 55,5 | 113,0 | - | 493,8 | 5 |
| 907404 | HELU-S-RK-CU-UL 500-16 | 500,0 | 17,0 | 31,0 | 55,5 | 113,0 | - | 493,8 | 5 |
| 907405 | HELU-S-RK-CU-UL 500-20 | 500,0 | 21,0 | 31,0 | 55,5 | 113,0 | - | 485,6 | 5 |
| 907406 | HELU-S-RK-CU-UL 630-16 | 630,0 | 17,0 | 34,0 | 60,0 | 115,0 | - | 513,5 | 5 |
| 907407 | HELU-S-RK-CU-UL 630-20 | 630,0 | 21,0 | 34,0 | 60,0 | 115,0 | - | 506,0 | 5 |

Допускаются технические изменения.